



SAMUEL WOOD

3 St Peters Mews, Dodmore Lane, Ludlow, Shropshire, SY8 2PZ

£825 PCM







## 3 St Peters Mews

Dodmore Lane, Ludlow, Shropshire, SY8 2PZ



MANAGED BY SAMUEL WOOD. Spacious two bedroom property in a convenient location, with driveway parking and enclosed garden.

This spacious 2 bedroom terraced house sits in a convenient location and enjoys driveway parking and an enclosed garden. Accommodation benefitting from gas fired heating includes: entrance hall, kitchen with a cooker and under counter fridge freezer, living room, first floor landing, 2 bedrooms, en-suite shower room and house bathroom with a bath.

At the back, low maintenance paved garden. To the front, the property is set aside from the road and has an offroad parking on a driveway.









## Directions

Available on a min 12 months tenancy.  
Unfurnished.  
No smoking/vaping.  
Pets considered (well behaved pets).  
EPC - D  
Council Tax Band – B  
Utilities (mains gas, mains electric, mains water, mains drainage)  
Parking situation – off street parking for 1 car







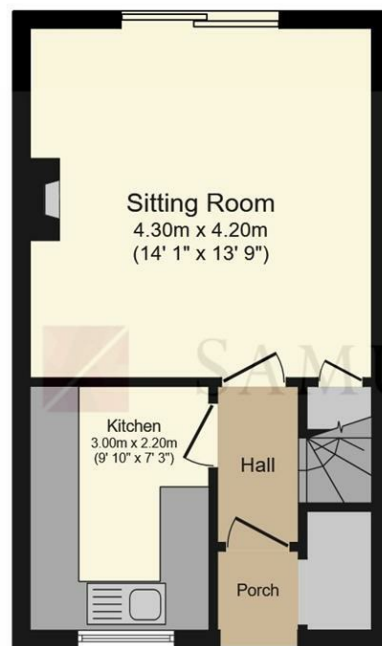

### Ground Floor

Floor area 31.1 sq.m. (334 sq.ft.)

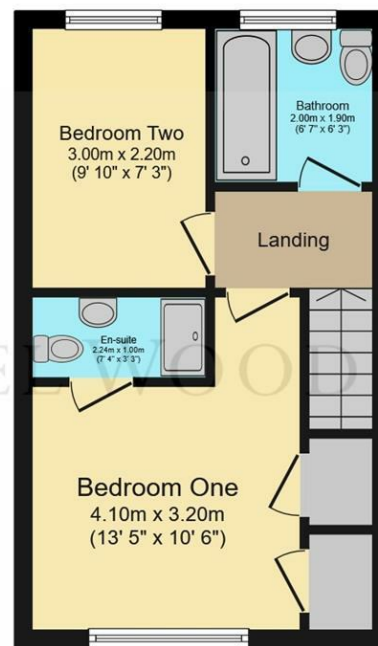

### First Floor

Floor area 31.0 sq.m. (334 sq.ft.)

**TOTAL: 62.1 sq.m. (668 sq.ft.)**

This floor plan is for illustrative purposes only. It is not drawn to scale. Any measurements, floor areas (including any total floor area), openings and orientations are approximate. No details are guaranteed, they cannot be relied upon for any purpose and do not form any part of any agreement. No liability is taken for any error, omission or misstatement. A party must rely upon its own inspection(s). Powered by [www.Propertybox.io](http://www.Propertybox.io)

We take every care in preparing our sales details. They are checked and usually verified by the Vendor. We do not guarantee appliances, alarms, electrical fittings, plumbing, showers etc. You must satisfy yourself that they operate correctly. Room sizes are approximate; they are usually taken in metric and converted to imperial. Do not use them to buy carpets or furniture. We cannot verify the tenure, as we do not have access to the legal title; we cannot guarantee boundaries or rights of way so you must take the advice of your legal representative. No person in the employment of or representing Samuel Wood has any authority to make any representation or warranty whatever in relation to this property. If there is any point which is of particular importance to you, please contact the office and we will be pleased to check the information. Do so particularly if contemplating travelling some distance to view. Applicants are advised that the majority of our shots are taken with a wide angle lens.

CONTEMPORARY AGENCY • TRADITIONAL VALUES

2 Shoplatch, Shrewsbury, Shropshire, SY1 1HF

Tel: 01743 272710 | [shrewsbury@samuelwood.co.uk](mailto:shrewsbury@samuelwood.co.uk)